



700 Marsolais Street
L'Assomption, Quebec
Canada J5W 2G9
Tel: (450) 589-1063
or 1-800-267-8243
Télec. : (450) 589-1711
Fax: (450) 589-1711
info@stageline.com

Stageline SL 320

A thorough understanding of the inter-related loadings shown in this rigging plan is needed in order to safely use this mobile stage roof and to take full advantage of the many rigging opportunities it offers.

This mobile stage roof offers a variety of rigging options with regard to load capacity, placement and type.

There are trusses, rigging pipes, front overhang rigging pipes, side overhang rigging beams, line array rigging beams and roof rigging points.

This rigging plan locates and defines these rigging features, includes load capacity for each and describes maximum combinations of loads amongst features.

Take note of exclusions, maximum sub-totals in a group, load balance requirements, maximum lifting capacity of roof and maximum rigging load on roof.

The maximum load on the roof is less than the sum of the maximum load on each rigging feature.

RIGGING RESTRICTIONS

Use both P1s or P2s or P3s, P4s or P5 alone on each T1 truss.

Use both P6s or P7s or P8s or P9 alone on each T2 truss.

Do not load more than 1000 lb (454 kg) on each twin set of P10 in upstage roof panel.

Do not load more than 500 lb (227 kg) on each twin set of P11.

Do not load P11s concurrently with truss T2 or when windwalls are installed.

Do not load P12s concurrently with P13 to P15.

Total load of P12 to P15 must not exceed 4000 lb (1814 kg).

Notes:

Outside diameter of rigging bars and of lower chord of trusses is 2" (5 cm).

Maximum Load Bearing Capacity - 26000 lb (11793 kg)

Rigging Point Maximum Load Capacity		
Point No.	Lb	Kg
P13, P14 & P15	4000	1814
P12	2000	907
P1 & P2	1500	680
P3	1200	544
P6 & P10	1000	454
P4 & P5	700	318
P7	650	295
P11	500	227
P8 & P9	400	182

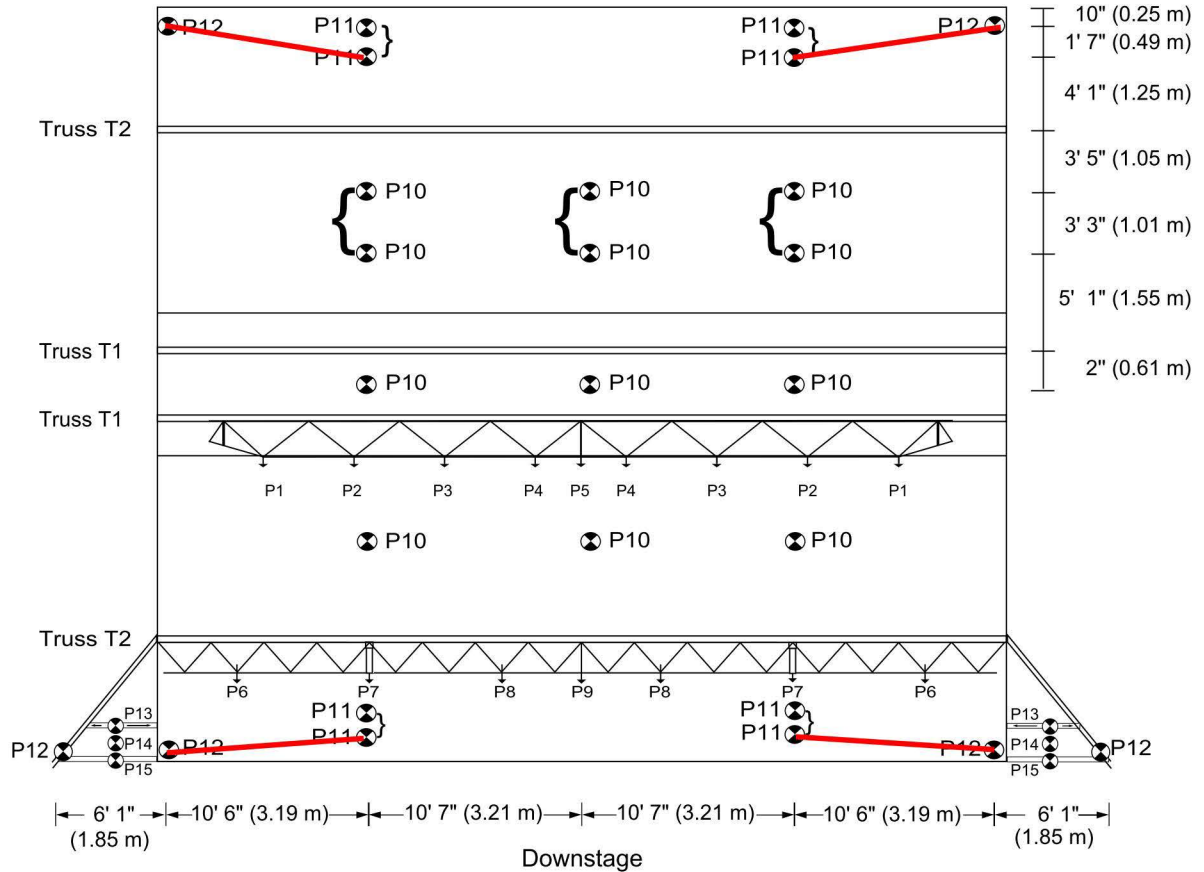

Rigging Plan with Bi-directional